

ROHS Compliant

408070

REVISIONS

RevNo	Description	Date	Revision	Mender
1	Change design for guest's cable	2012/08/06	A2	CKQ
2	SHELL MATERIAL:ZINC	2012/09/06	A3	CKQ

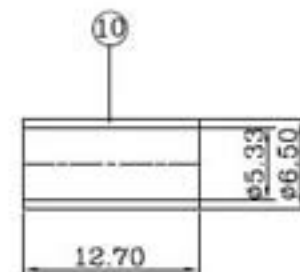
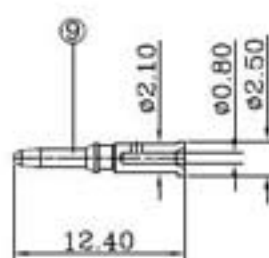
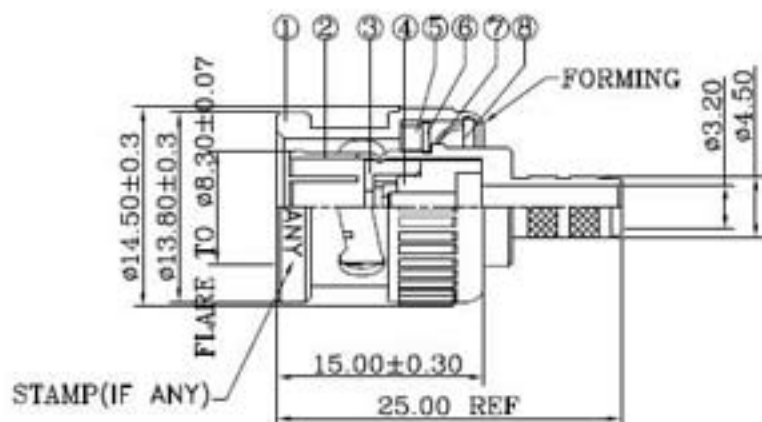

NOTES:FINISH (PLATING THICKNESS IN MICRO-INCHES)

- 1.BRASS PER QQ-B-626
- 2.NICKEL PL.100 MIN. THICK OVER COPPER STRIKE
- 3.NICKEL PL.200 MIN. THICK OVER COPPER STRIKE
- 4.GOLD PL.3 MIN THICK OVER NICKEL PL.100 MIN. THICK OVER COPPER STRIKE
- 5.JIS H 3250,C 2700

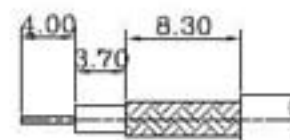

HEX CRIMP SIZE .319"
2.CRIMPED CONTACT PIN
HEX CRIMP SIZE .068"
OR TO SOLDER

RECOMMENDED
CABLE STRIPPING DIM'S

"Merce non prodotta in UE" - "Goods are not produced in UE"

10	FERRULE	NOTE 5	1	NOTE 2
9	CONTACT PIN	NOTE 1	1	NOTE 4
8	WASHER	IRON	1	NOTE 2
7	SPRING	SK5	1	NOTE 3
6	RETAINER RING	65Mn	1	NOTE 2
5	GASKET	RUBBER	1	RED
4	INSULATOR	POM	1	NATURAL
3	INSULATOR	POM	1	NATURAL
2	BODY	NOTE 1	1	NOTE 2
1	SHELL	ZINC	1	NOTE 2
ITEM	DESCRIPTION	MATERIAL	Q'TY	FINISHED

ELAN
CAVI E BATTERIE



TITLE
BNC CRIMP PLUG 75 OHMS
(FOR MINI RG59U CABLE)

DRAWING NO.	UNITS	MM	UNLESS OTHERWISE SPECIFIED	DESIGNED	Ckg
MODEL NO.	SCALE	FIT	TOLERANCES: 0.3-0.6 = ±0.20 0.6-3.0 = ±0.40 3.0-12.0 = ±0.60 12.0-30.0 = ±1.00 30.0-100.0 = ±1.6 100.0-200.0 = ±2.4	DRAWING	Ckg
PART NO.	EDITION	A1	ANGLES ±5°	CHECKED	
CAD FILE			PUBLISH DATE	APPROVED	
			2012/06/18		3RD ANGLE